

**ROUND CEILING DIFFUSER**

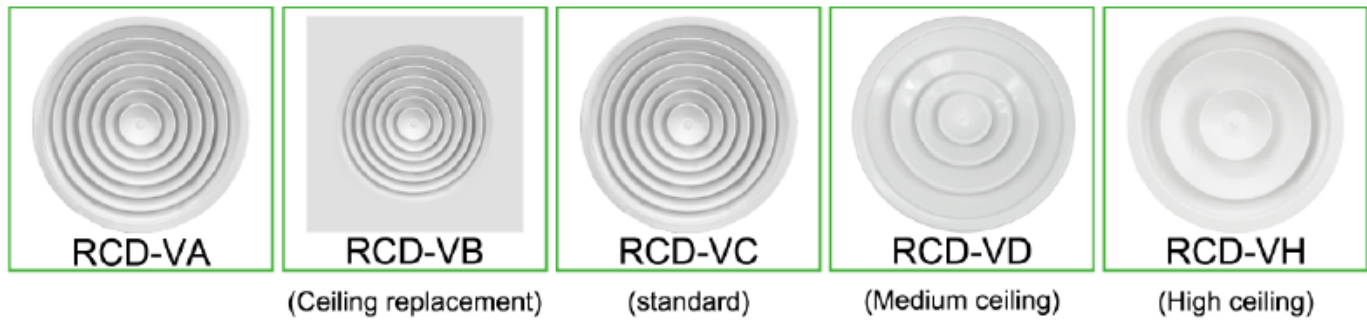

- \* The circular design guarantees an uniform radial discharge in supply air applications.
- \* They can be used both for supply and return applications.
- \* They are suitable for using in rooms with heights up to 4m(A,B,C designs), 6m(D design), 8M(H design)
- \* Material: They are made of aluminum sheet.
- \* Accessories: Damper ( butterfly damper in plastic or steel manual control; radial-shape damper screw control.)
- \* Mounting: Screw type.
- \* Finishing: White powder coating Ral9016, Ral9010, or customized color. Anodized.

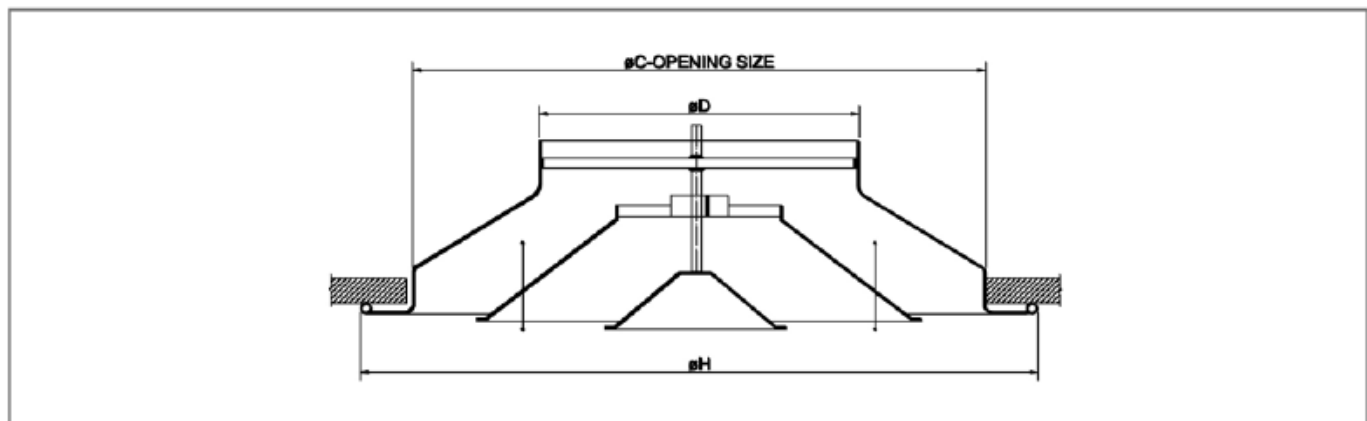
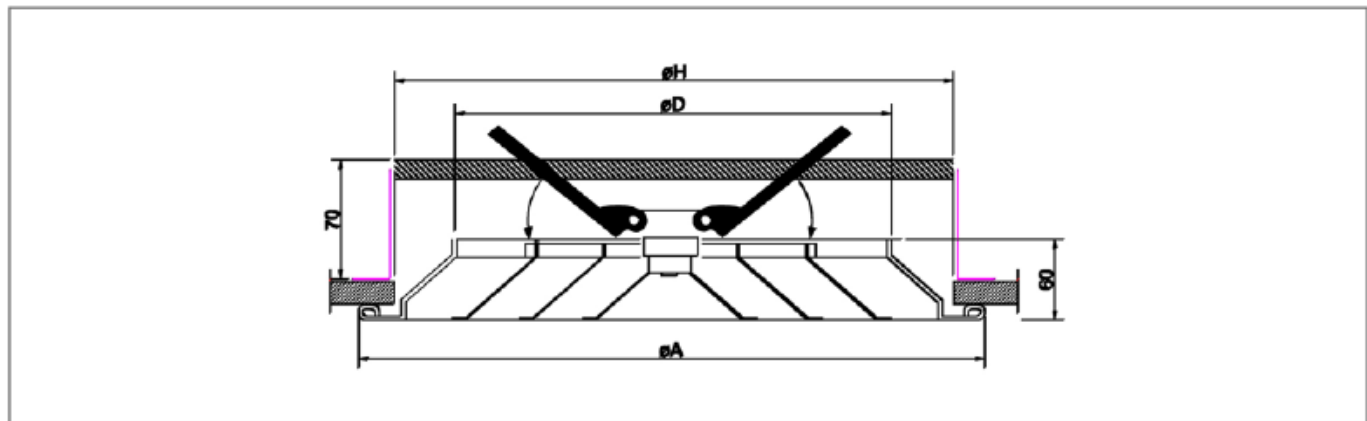

## ROUND CEILING DIFFUSER

### Selection Tables

Size(mm)	RCD-VA, VC øD(mm)	RCD-VA, VC øA(mm)	RCD-VB øA(mm)	Air volume (m <sup>3</sup> /h)	Throw Max. (m)
150	145	250	595x595	135	0.8
200	195	300	595x595	240	1.3
250	245	350	595x595	360	1.55
300	295	400	595x595	500	1.8
350	345	450	595x595	666	2.2
400	395	500	595x595	810	2.4
450	445	550	595x595	1050	2.7
500	495	600	595x595	1215	2.9

Size(mm)	RCD-VD øD(mm)	RCD-VD øA(mm)	Air volume (m <sup>3</sup> /h)	Throw Max. (m)
150	145	300	148	0.9
200	195	395	260	1.5
250	245	445	395	1.8
300	295	495	560	2.3
350	345	545	750	2.8

Size(mm)	RCD-VH øD(mm)	RCD-VH øA(mm)	Air volume (m <sup>3</sup> /h)	Throw Max. (m)
150	145	325	160	1.4
200	195	430	285	2.3
250	245	530	445	2.7
300	295	640	640	3.1
350	345	720	865	3.6

Data were chosen when the air velocity is 2.5m/s and the velocity at throw distance is 0.25m/s.

## Round Ceiling Diffuser Data

RCD-VA, VB, VC			AIR VOLUME(m <sup>3</sup> /h)													
Size (mm)	Effective Area(m <sup>2</sup> )		150	200	300	400	500	600	700	800	900	1000	1400	2000	2500	
150	0.011	Vk(m/s)	3.8	5.2	7.8	-	-	-	-	-	-	-	-	-	-	-
		Pt(pa)	15	24	65	-	-	-	-	-	-	-	-	-	-	-
		Lt(m)	2.2	2.8	4.5	-	-	-	-	-	-	-	-	-	-	-
		NR	-	28	48	-	-	-	-	-	-	-	-	-	-	-
200	0.020	Vk(m/s)	2.3	2.8	4.5	6.0	7.4	-	-	-	-	-	-	-	-	-
		Pt(pa)	5.4	7.9	20	30	60	-	-	-	-	-	-	-	-	-
		Lt(m)	1.6	2.2	3.4	4.5	4.5	-	-	-	-	-	-	-	-	-
		NR	-	-	27	36	48	-	-	-	-	-	-	-	-	-
250	0.031	Vk(m/s)	-	-	2.8	3.8	4.6	5.5	6.5	7.5	-	-	-	-	-	-
		Pt(pa)	-	-	7.9	16	21	26	41	62	-	-	-	-	-	-
		Lt(m)	-	-	2.7	3.1	4.5	5.4	6.2	4.5	-	-	-	-	-	-
		NR	-	-	-	-	30	36	42	48	-	-	-	-	-	-
300	0.046	Vk(m/s)	-	-	-	2.5	3.1	3.7	4.3	5.0	5.5	6.2	-	-	-	
		Pt(pa)	-	-	-	6.5	9	15	19	22	26	34	-	-	-	
		Lt(m)	-	-	-	2.8	3.6	4.7	5.3	6	7	6.2	-	-	-	
		NR	-	-	-	-	-	25	30	35	38	42	-	-	-	
350	0.055	Vk(m/s)	-	-	-	2.0	2.5	3.0	3.5	4.0	4.5	5.0	7.0	-	-	
		Pt(pa)	-	-	-	4.2	6.5	8	13	17	20	22	51	-	-	
		Lt(m)	-	-	-	2.6	3.2	3.7	4.7	5.2	6	7	9.8	-	-	
		NR	-	-	-	-	-	-	24	27	33	36	47	-	-	
400	0.070	Vk(m/s)	-	-	-	-	2.0	2.4	2.8	3.3	3.6	4.0	5.5	-	-	
		Pt(pa)	-	-	-	-	4.2	6.1	7.9	11	14	17	26	-	-	
		Lt(m)	-	-	-	-	2.8	3.4	4.2	4.7	5.2	6	9	-	-	
		NR	-	-	-	-	-	-	-	23	26	30	42	-	-	
450	0.089	Vk(m/s)	-	-	-	-	-	-	2.3	-	2.8	3.1	4.2	6.0	-	
		Pt(pa)	-	-	-	-	-	-	5.4	2.4	7.9	9	18	30	7.8	
		Lt(m)	-	-	-	-	-	-	3.4	6.1	4.6	5.1	8	10.5	65	
		NR	-	-	-	-	-	-	-	4.2	-	23	34	46	13	
500	0.108	Vk(m/s)	-	-	-	-	-	-	-	2.0	-	2.5	3.6	5.0	6.2	
		Pt(pa)	-	-	-	-	-	-	-	4.2	2.3	6.5	14	22	34	
		Lt(m)	-	-	-	-	-	-	-	3.6	5.2	4.6	7	10	12	
		NR	-	-	-	-	-	-	-	-	4.2	-	28	41	48	

## Round Ceiling Diffuser Data

RCD-VD			AIR VOLUME(m <sup>3</sup> /h)													
Size (mm)	Effective Area(m <sup>2</sup> )		200	300	400	500	600	700	800	900	1000	1400	2000	2500	3000	
150	0.011	Vk(m/s)	3.7	5.8	7.8	-	-	-	-	-	-	-	-	-	-	-
		Pt(pa)	15	36	63	-	-	-	-	-	-	-	-	-	-	-
		Lt(m)	0.7	1.15	1.4	-	-	-	-	-	-	-	-	-	-	-
		NR	25	38	48	-	-	-	-	-	-	-	-	-	-	-
200	0.020	Vk(m/s)	2.1	3.2	4.2	5.2	6.1	7.3	-	-	-	-	-	-	-	
		Pt(pa)	4.7	10	19	29	40	56	-	-	-	-	-	-	-	-
		Lt(m)	-	0.8	1.15	1.35	1.7	1.9	-	-	-	-	-	-	-	-
		NR	-	22	31	38	45	52	-	-	-	-	-	-	-	-
250	0.031	Vk(m/s)	-	2.2	2.8	3.5	4.2	4.9	5.6	6.2	7.2	-	-	-	-	
		Pt(pa)	-	5.1	7.9	13	19	26	25	43	53	-	-	-	-	-
		Lt(m)	-	0.65	0.85	1.15	1.4	1.6	1.8	2.1	2.4	-	-	-	-	-
		NR	-	-	21	27	33	38	44	47	50	-	-	-	-	-
300	0.046	Vk(m/s)	-	-	2.0	2.5	3.0	3.5	4.0	4.5	5.0	7.0	-	-	-	
		Pt(pa)	-	-	4.2	6.5	9	13	1.7	22	26	51	-	-	-	
		Lt(m)	-	-	0.72	0.92	1.1	1.35	1.5	1.7	1.8	2.7	-	-	-	
		NR	-	-	-	-	24	29	34	37	42	-	-	-	-	-
350	0.055	Vk(m/s)	-	-	-	-	2.2	2.6	3.0	3.4	3.7	5.2	-	-	-	
		Pt(pa)	-	-	-	-	5.1	7.3	9	12	15	29	7.5	-	-	
		Lt(m)	-	-	-	-	0.9	0.9	1.4	1.5	1.6	2.4	5.9	-	-	
		NR	-	-	-	-	-	-	26	30	37	45	3.5	-	-	

RCD-VH			AIR VOLUME(m <sup>3</sup> /h)												
Size (mm)	Effective Area(m <sup>2</sup> )		200	300	400	500	600	700	800	900	1000	1400	2000	2500	3000
150	0.011	Vk(m/s)	3.3	4.6	6.3	-	-	-	-	-	-	-	-	-	-
		Pt(pa)	30	49	85	-	-	-	-	-	-	-	-	-	-
		Lt(m)	3.4	4.5	6.0	-	-	-	-	-	-	-	-	-	-
		NR	30	41	52	-	-	-	-	-	-	-	-	-	-
200	0.020	Vk(m/s)	-	2.6	3.5	4.4	5.6	-	-	-	-	-	-	-	
		Pt(pa)	-	17	31	49	68	-	-	-	-	-	-	-	-
		Lt(m)	-	1.8	2.9	3.8	4.7	-	-	-	-	-	-	-	-
		NR	-	22	31	45	67	-	-	-	-	-	-	-	-
250	0.031	Vk(m/s)	-	-	2.3	2.9	3.4	4.0	4.5	5.1	5.9	-	-	-	
		Pt(pa)	-	-	13	20	25	31	37	46	64	-	-	-	
		Lt(m)	-	-	1.3	2.1	2.6	3.1	3.6	3.9	4.7	-	-	-	
		NR	-	-	14	23	27	31	36	40	46	-	-	-	
300	0.046	Vk(m/s)	-	-	-	2.0	2.4	2.6	2.8	3.5	4.0	4.8	-	-	
		Pt(pa)	-	-	-	11	14	16	18	25	34	68	-	-	
		Lt(m)	-	-	-	0.8	1.4	1.7	2.1	2.3	2.8	4.2	-	-	
		NR	-	-	-	15	20	24	27	30	35	45	-	-	
350	0.055	Vk(m/s)	-	-	-	-	-	2.0	2.3	2.7	3.1	4.0	5.9	-	
		Pt(pa)	-	-	-	-	-	11	14	18	22	38	80	-	
		Lt(m)	-	-	-	-	-	0.8	0.9	1.1	1.7	2.9	3.8	-	
		NR	-	-	-	-	-	16	2	24	27	35	48	-	